

M32D...

Shoulder milling cutters at 90°
Fraises à dresser à 90°
Eckmesserkopf 90°
Fresas para escuadrar à 90°

Frese per spallamenti a 90° per inserto APKT1003

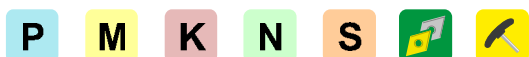
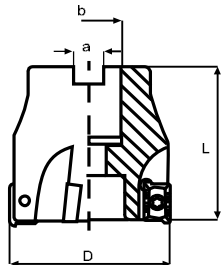

Codice Code	Dimensioni / Dimensions					Inserto Insert	Parti di ricambio / Spare parts	
	D	Z	L	a	b			
M32D40	40	6	40	8.4	16	APKT1003	TX2506	BTX08
M32D50	50	7	40	10.4	22	APKT1003	TX2506	BTX08
M32D63	63	8	40	10.4	22	APKT1003	TX2506	BTX08

MATERIALI - MATERIALS	HB	fz (mm)	ap (mm)	Velocità di Taglio - Cutting Speed - Vc m/min						
				PM2440	PM4125	PM4325	PM4530	PM6515	PM4135	WM8010
P ACCIAIO NON LEGATO - NOT ALLOY STEEL ACCIAIO LEGATO - ALLOY STEEL ACCIAIO ALTO LEGATO - HIGH ALLOY STEEL	120-300	0,2	1-3		200	250	260		160	
	180-350	0,15	1-3		160	200	220		140	
	300-330	0,15	1-3		140	150	180		120	
M INOXAUSTENITICO - DUPLEX - STAINLESS STEEL	180-230	0,1	1-3	140	120				130	
K GHISA GRIGIA - GREY CAST IRON GHISA SFEROIDALE - SPHEROIDAL CAST IRON GHISA MALLEABILE - MALLEABLE CAST IRON	120-260	0,25	1-3					250		
	160-250	0,2	1-3					200		
	130-230	0,2	1-3					200		
N ALLUMINIO E SUE LEGHE - ALUMINIUM RAME E SUE LEGHE - COPPER NON METALLICI - PLASTICS	60-130	0,2	1-3							500
	90-110	0,15	1-3							300
		0,15	1-3							
S LEGHE RESIST. AL CALORE - HIGH TEMP. ALLOY TITANIO E SUE LEGHE - TITANIUM	200-320	0,1	1-3				40	40		
	400-1050	0,1	1-3				40	50		

Tipo di lavorazione - Recommended machining types

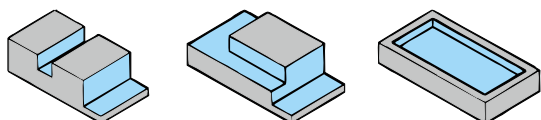

D x 4



H 2 - H 7

