

## M52D...

Shoulder milling cutters at 90°  
Fraises à dresser à 90°  
Eckmesserkopf 90°  
Fresas para escuadrar à 90°

Frese per spallamenti a 90° per inserto APKT1604

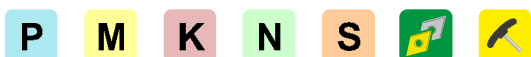
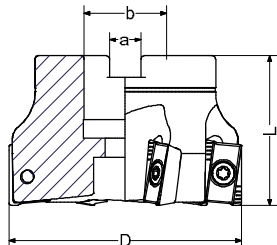

Codice Code	Dimensioni / Dimensions					Inserto Insert	Parti di ricambio / Spare parts	
	D	Z	L	a	b			
M52D40	40	4	40	8.4	16	APKT1604	TX4010	BTX15
M52D50	50	5	40	10.4	22	APKT1604	TX4010	BTX15
M52D63	63	6	40	10.4	22	APKT1604	TX4010	BTX15
M52D80	80	7	50	12.4	27	APKT1604	TX4010	BTX15
M52D100	100	8	50	14.4	32	APKT1604	TX4010	BTX15
M52D125	125	9	63	16.4	40	APKT1604	TX4010	BTX15
M52D160	160	10	63	16.4	40	APKT1604	TX4010	BTX15

MATERIALI - MATERIALS	HB	fz (mm)	ap (mm)	Velocità di Taglio - Cutting Speed - Vc m/min							
				PM2440	PM4125	PM4325	PM4530	PM6515	PM4135	WM8010	
<b>P</b> ACCIAIO NON LEGATO - NOT ALLOY STEEL	120-300	0,2	1-3		200	250	260		160		
ACCIAIO LEGATO - ALLOY STEEL	180-350	0,15	1-3		160	200	220		140		
ACCIAIO ALTO LEGATO - HIGH ALLOY STEEL	300-330	0,15	1-3		140	150	180		120		
<b>M</b> INOX AUSTENITICO - DUPLEX - STAINLESS STEEL	180-230	0,1	1-3	140	120				130		
GHISA GRIGIA - GREY CAST IRON	120-260	0,25	1-3					250			
<b>K</b> GHISA SFEROIDALE - SPHEROIDAL CAST IRON	160-250	0,2	1-3					200			
GHISA MALLEABILE - MALLEABLE CAST IRON	130-230	0,2	1-3					200			
<b>N</b> ALLUMINIO E SUE LEGHE - ALUMINIUM	60-130	0,2	1-3							500	
RAME E SUE LEGHE - COPPER	90-110	0,15	1-3							300	
NON METALLICI - PLASTICS		0,15	1-3								
<b>S</b> LEGHE RESIST. AL CALORE - HIGH TEMP. ALLOY	200-320	0,1	1-3				40	40			
TITANIO E SUE LEGHE - TITANIUM	400-1050	0,1	1-3				40	50			

Tipo di lavorazione - Recommended machining types

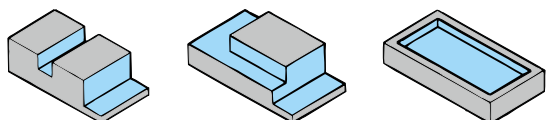

D x 4



H 2 - H 7

